

Perfect PEAK[®]

HPLC/UHPLC STATIC MIXERS

TEESING

WE MAKE YOUR TECHNOLOGY WORK

mott

MISSION CRITICAL PRECISION

PerfectPeak[®] Static Mixers offer **UP TO 80% BASELINE NOISE REDUCTION**, **IMPROVED DETECTION LIMITS**, and are **EASILY INSTALLED** into any system

DESCRIPTION

Available in 25, 50, 100, and 150 μ L versions.

PerfectPeak[®] HPLC Static Mixers utilize unique mixing pathways and provide key benefits such as:

- Significant baseline noise reduction
- Less dwell volume than comparable mixers
- Compatibility with a wide range of flow rates
- Quick installation into any HPLC system



BASELINE NOISE

Perfect PEAK[®]

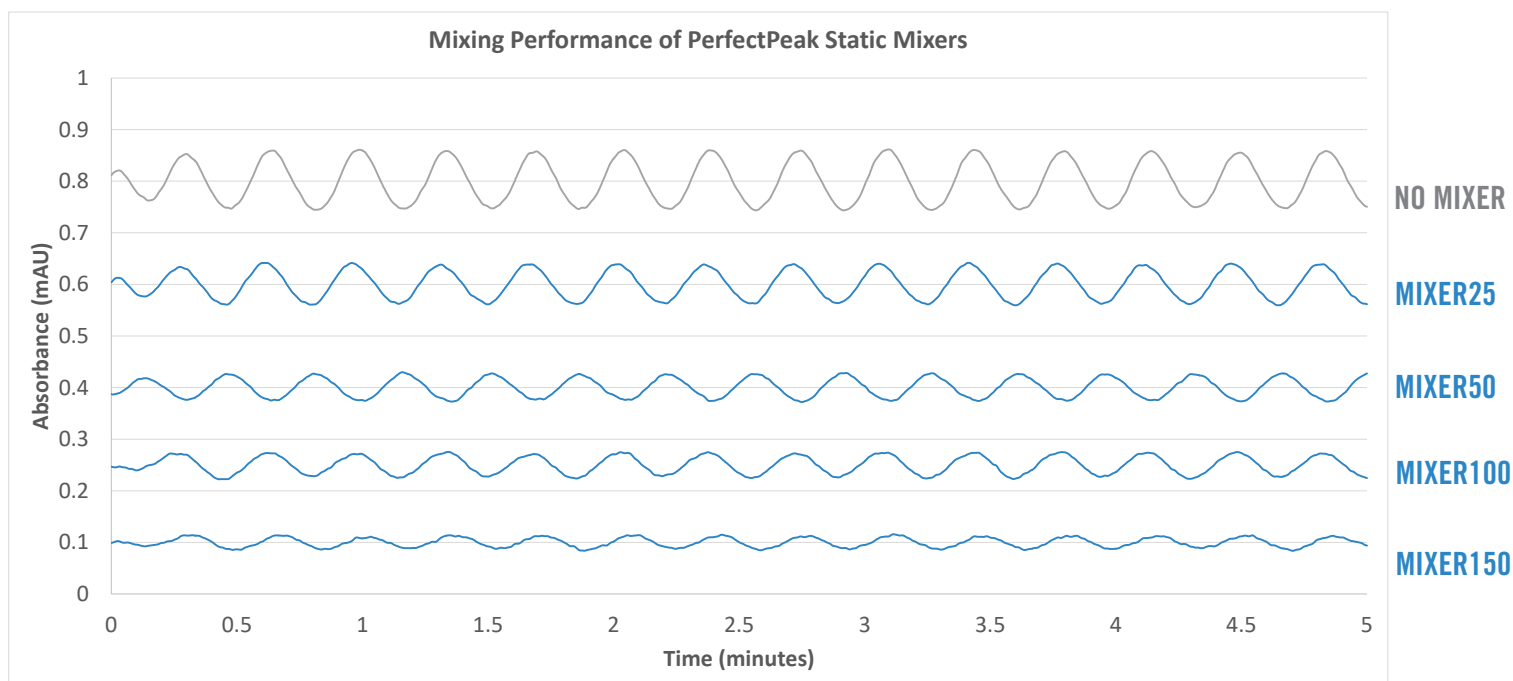

PRODUCT SPECIFICATIONS

	MIXER25	MIXER50	MIXER100	MIXER150
Internal Volume	25 μ L	50 μ L	100 μ L	150 μ L
Material of Construction	Passivated 316(L) SS			
Pressure Rating	20,000 PSIG / 1379 bar			
Connection Type	Female Compression			
Connection Size	1/16" / 1.59 mm Tube			
*Custom connections are available upon request				

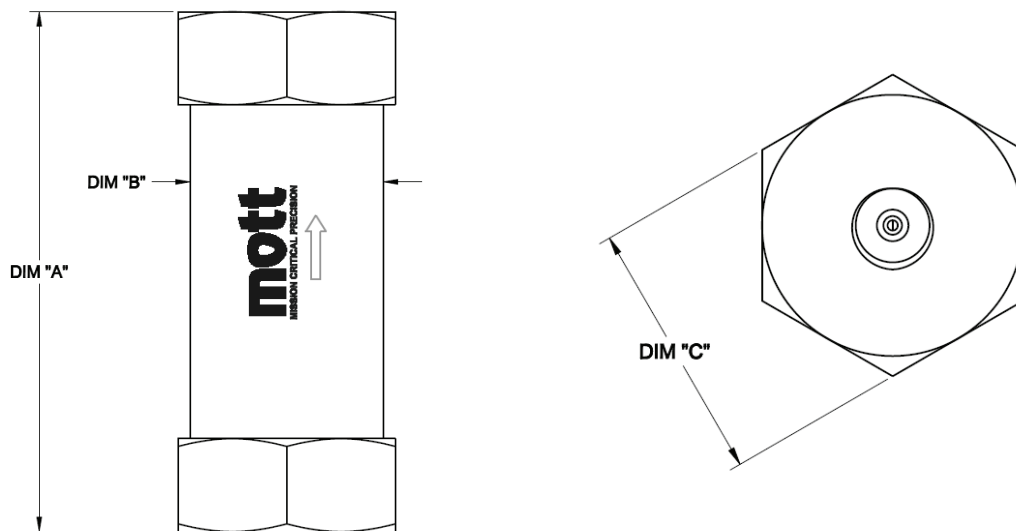

ORDERING INFORMATION

Mixer Volume	"A" Inches/mm	"B" Inches/mm	"C" Inches/mm	Part Number
MIXER25	1.35 / 34.29	0.50 / 12.70	0.56 / 14.22	1850011-01-3D
MIXER50	1.70 / 43.18	0.50 / 12.70	0.56 / 14.22	1850012-01-3D
MIXER100	2.40 / 60.96	0.50 / 12.70	0.56 / 14.22	1850014-01-3D
MIXER150	2.75 / 69.85	0.50 / 12.70	0.56 / 14.22	1850015-01-3D

HPLC Conditions for Mixer Testing Performance

Solvent A: 20 mM Solution of Ammonium Acetate in DI H₂O

Mix Ratio: 20% A / 80% B

Detector: Agilent G1314F VWD

Injector: No Injection

HPLC Column: Column and Injector Bypassed - Pressure Regulator Employed

Solvent B: 80% Acetonitrile (ACN) / 20% DI H₂O

Flow Rate: 0.5 mL/min

Instrument: Agilent 1260 Binary Pump

Wavelength: 220 nm

Perfect PEAK[®]